



# A connected energy management solution for air-conditioners

“ I want to avoid energy bill surprises! ”



## Energy Management by Wisier the connected electrical panel for residential installations

### Customer story

Each winter, the Smiths rely heavily on their reverse cycle air-conditioner to keep their house warm. Two years ago, they got a nasty shock when they received a huge electricity bill, as a result of their excessive heating. Mrs Smith has encouraged her daughters to pay attention to consumption, but little has changed. So, this year, she has adopted the Energy Management by Wisier solution. Now, via her smartphone, she can track their energy consumption to be sure that she does not have any unpleasant surprises at the end of each month.

### Proposed solution

MAX4 is an innovative switchboard offer for the residential market comprising of:

**Best-in-class** home protection devices born out of almost **100 years** of Clipsal by Schneider Electric experience.

**Ingenious** and **Optimum** enclosure in surface or flush-mounted versions.

**Energy Management by Wisier** system that connects your clients to their electrical panel directly from their smartphone. It includes:

- PowerTag energy sensors to monitor total consumption or specific loads
- Wisier IP module that concentrates sensors' data before uploading it on the internet
- Easy-to-use commissioning app.

### Customer benefits

#### For Mr and Mrs Smith:

- **Peace of mind:** notification in the event that energy consumption exceeds their monthly target
- **Efficiency:** the means to track their home and electrical heating consumption, at any time.

#### For electricians:

- **Grow your revenues:** by discovering new connectivity-related business opportunities
- **Improve business efficiency:** easy to commission with the eSetUp app, simple to install
- **Provide your customers with safer and efficient installations.**



## Applications

- Apartment
- House
- ....

Connected energy management  
+ smartphone application  
= efficient activity

## What you need

### Home/Apartment owner:

- A mobile device or PC and an internet box.
- Wiser Energy app from App store or Google Playstore

### Electrician:

- No PC is required during installation and commissioning of the products.  
Commissioning is done via Bluetooth with **My Schneider Electrician eSetup smartphone app**.

## Solution diagram

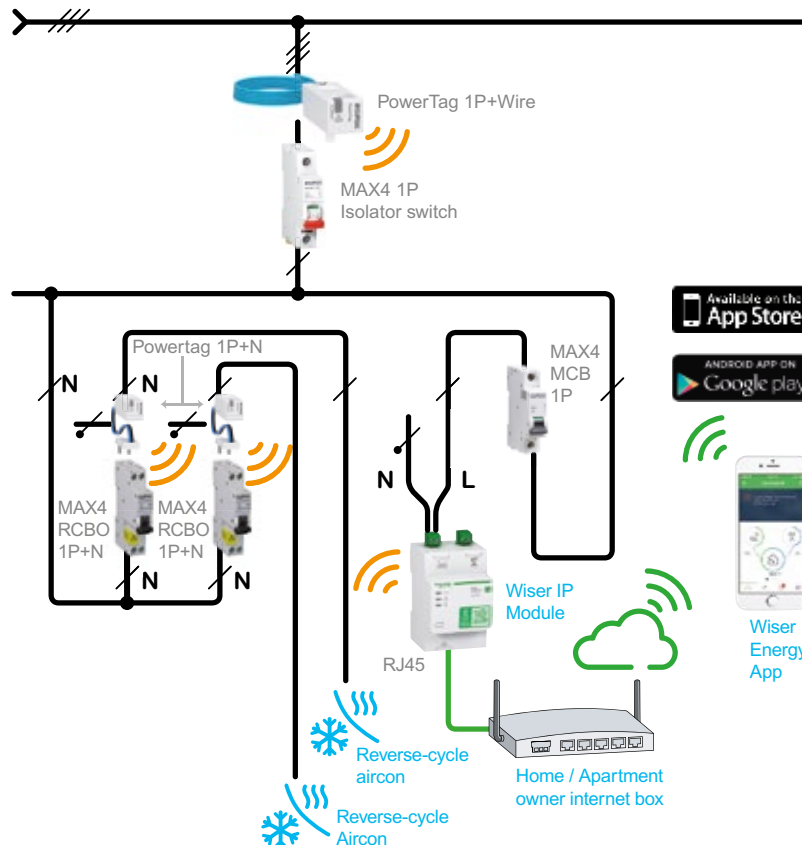

## Products used

| Product                                 | Function  | Quantity          | Cat. no.   |
|---|---|-------------------|--|
| 1 row MAX4 surface (or flush) enclosure | -   | 1                 | 4C17FD-WE<br>(or 4FC17FD-WE)                       |
| Wiser IP Module                         | IP communication module   | 1                 | EER72600   |
| Powertag 1P + Wire                      | Add-on energy sensor  | 1                 | 4CBEM1   |
| Powertag 1P + N                         | Add-on energy sensor  | 2                 | 4RCBEM2T   |
| Isolator Switch 1P                      | Main incomer  | 1                 | 4CB1xx/6 or 4MSW1100<br>(depending on local rules) |
| MAX4 SLIM RCBO 1P+N                     | Protection of cooking plate, oven, light circuits, power circuits, etc. | Depending on need | 4RCBE2xx/30S<br>(xx represents current rating)     |
| MAX4 SLIM RCBO 1P+N                     | Protection of reverse cycle aircons                                     | 2                 | 4RCBE2xx/30S<br>(xx represents current rating)     |
| MCB 1 pole A                            | Protection of cable to Wiser IP module                                  | 1                 | 4CB1xx/6<br>(xx represents current rating)         |

Schneider Electric (Australia) Pty. Ltd.  
33-37 Port Wakefield Road,  
Gepps Cross, South Australia, 5085  
PO Box 132, Enfield Plaza,  
South Australia, 5085

[clipsal.com/wiserenergy](http://clipsal.com/wiserenergy)

National Customer Care  
Phone: 137328

© 2019 Schneider Electric. All rights reserved.

Life Is On

**CLIPSAL**  
by Schneider Electric