

Our 56 Series DOL Starters now come with emergency braking



We've outdone ourselves again!

The revolutionary 56 Series DOL 9, 12 and 16 Starters have been redesigned with a new larger, high visibility stop button for faster response in an emergency.

This 40mm Mushroom Head button is an integral part of the lid and now comes standard with all models in the range at no extra cost.



Safety that's right on the button!

Impact, water, dust and UV resistant IP66 rated housing

Captive stainless steel combination head screws

Made right here in Australia

Heavy duty wall sections

Ample wiring room

Redesigned fully integrated 40mm diameter mushroom head stop button

Contactor support cradle for fast, easy installation and allows compatibility with the entire 56 Series range

Metric threaded entries in enclosure
1 x 32mm top
2 x 25mm bottom (fully reversible)

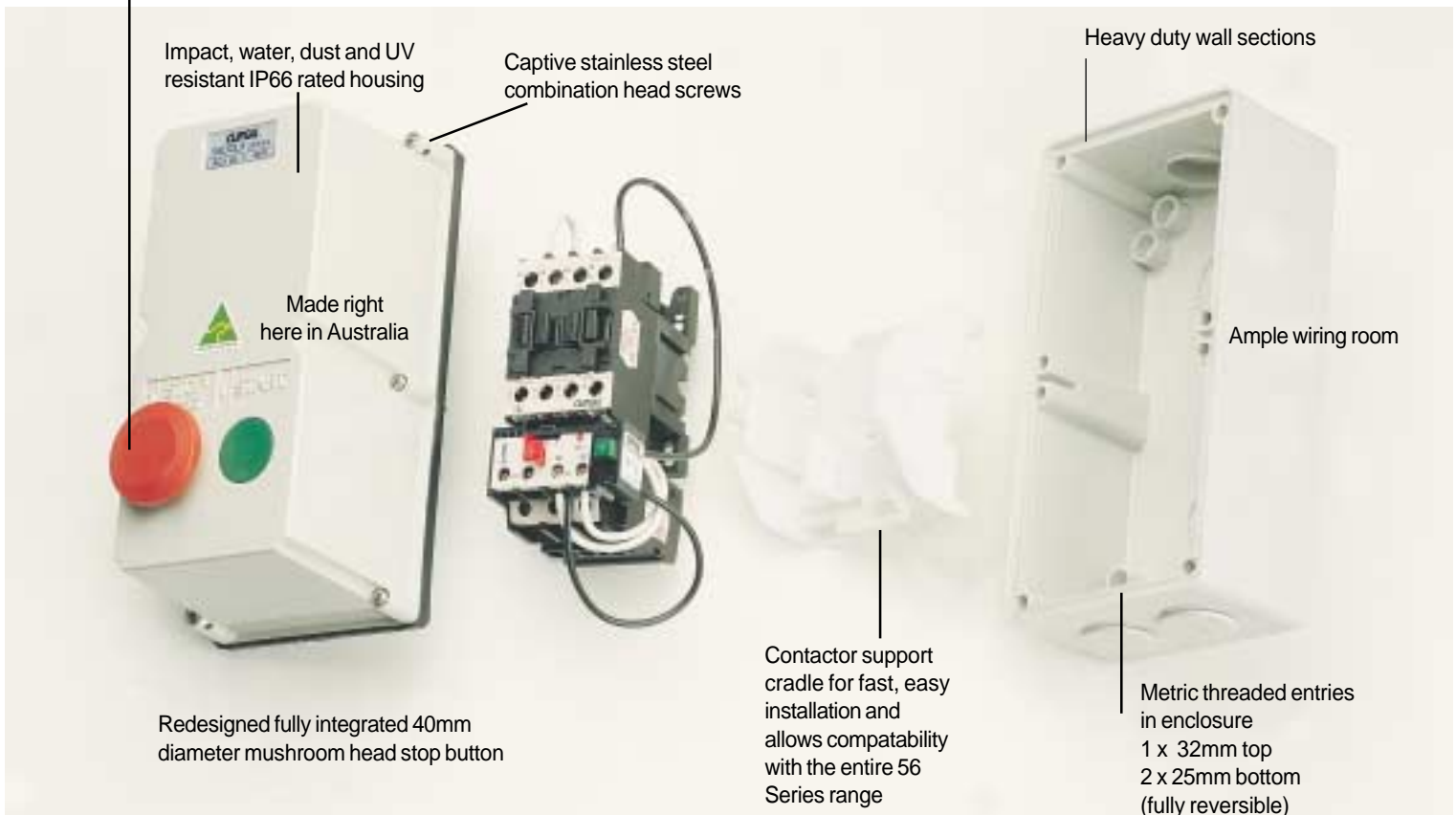

Safety, performance, flexibility & value for money

Modular flexibility

These motor starters can easily be linked to virtually any number of 56 Series modules in one enclosure. This avoids time wasting cable runs between separate equipment enclosures.

Easy wiring

Our minimum two gang enclosure ensures ample wiring room and entry for Australian Standard metric threaded conduits.

UV stabilised

Even in the harsh Australian sun, you can rely on the 56 Series' proven outdoor performance.

Heavy duty impact resistant enclosure

Base enclosure wall sections of 5-7mm combined with polycarbonate covers offer outstanding resistance to distortion and impact damage.

Hoseproof and dustproof to IP66

56DOL Series products are built tough to withstand the worst of Australia's harsh climate.

56 Series colour range

All 56 Series motor starter enclosures are available in UV stabilised light grey. Also available is a range of chemically resistant orange (RO) enclosures for environmentally aggressive locations such as chemical plants, timber & paper processing, dairies and food processing plants.

Available options

The new Clipsal 56DOL Series with Mushroom Head Stop Button is available in the following configurations for all your needs:



Specifications

Catalogue No.	Motor Rating	Description
56DOL9	4kW	DOL Starter, with overload, 2 push-buttons
56DOL9SW	4kW	DOL Starter, with overload, 2 push-buttons, isolating switch
56ROL9SD	4kW	Roller Shutter Door Version, 2 push-buttons (stop/reset & start, up/off/down) isolating switch
56ROL9SW	4kW	Reversing DOL Starter, with overload, 2 push-buttons, fwd/off/ rev. isolator
56DOL12	5.5kW	DOL Starter, with overload, 2 push-buttons
56DOL12SW	5.5kW	DOL Starter, with overload, 2 push-buttons and isolating switch
56ROL12SW	5.5kW	Reversing DOL Starter, with overload, 2 push-buttons, fwd/off/ rev. isolator
56DOL16	7.5kW	DOL Starter, with overload, 2 push-buttons
56DOL16SW	7.5kW	DOL Starter, with overload, 2 push-buttons and isolating switch
56ROL16SW	7.5kW	Reversing DOL Starter with overload, 2 push-buttons, fwd/off/ rev isolator



Spare parts

The above starters are available less enclosure (LE), e.g. 56DOL12SWLE.

Standard control voltages available for the above variations are 480, 415, 240, 110, 48, 32 & 24 Volts a.c. Also available with latching stop button to special order. (The buttons for this version are not an integral part of the cover.)



Legendary 56 Series quality and adaptability

Clipsal Controlgear

**Part of
Australia's Greatest Range**



56DOL9



56DOL9SW



56ROL9SW



56ROL9SD

Full details on the Clipsal 56 Series are provided in our technical catalogue.

Please contact your Clipsal Representative for further information.

The products presented in this catalogue are supplied by Clipsal Controlgear, a Joint Venture Company with Lovato.



Clipsal Controlgear Technical Hotline 1800 622 557

Products of Clipsal Controlgear Pty Ltd

ABN 30 008 265 129
Telephone (08) 8269 0594
Facsimile (08) 8340 1004
Email mandy.mallon@clipsal.com.au

Clipsal Controlgear Hotline
(for technical information) 1800 622 557

A division of Gerard Industries Pty Ltd
ABN 27 007 873 529

Head Office
12 Park Terrace, Bowden
South Australia 5007
Telephone (08) 8269 0511
Facsimile (08) 8340 1724
Internet www.clipsal.com
Internet www.alfredonline.com.au
E-Mail plugin@clipsal.com.au

Offices in all States

NSW Sydney (02) 9794 9200
Albury (02) 6041 2377
VIC Melbourne (03) 9207 3200
Country areas 1800 653 893
QLD Brisbane (07) 3244 7444
Townsville (07) 4729 3333
SA Adelaide (08) 8269 0555
WA Perth (08) 9442 4444
TAS Hobart (03) 6272 3177
Launceston (03) 6343 5900
NT Darwin (08) 8947 0278

International Enquiries

Head Office Export Department
Telephone + 61 8 8269 0587
Facsimile +61 8 8340 7350
E-Mail export@clipsal.com.au

Customer Service

Free Fax (0508) 250 305
Auckland/Mobile Phone (09) 572 0014
Free Phone (0508) CLIPSAL
254 7725